

カルチャードマーブルでしかできないこと！

アクセントライン …… ノンドリップへの回帰

(86 & 86プラス 20)

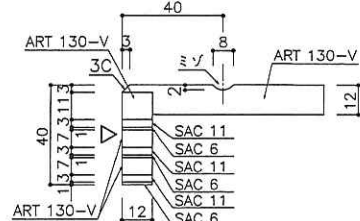
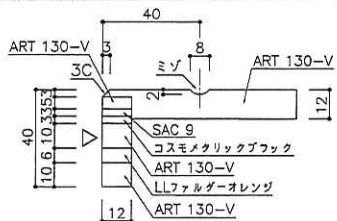
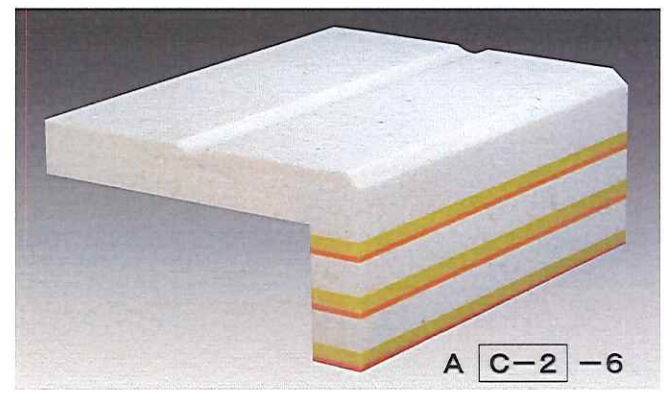
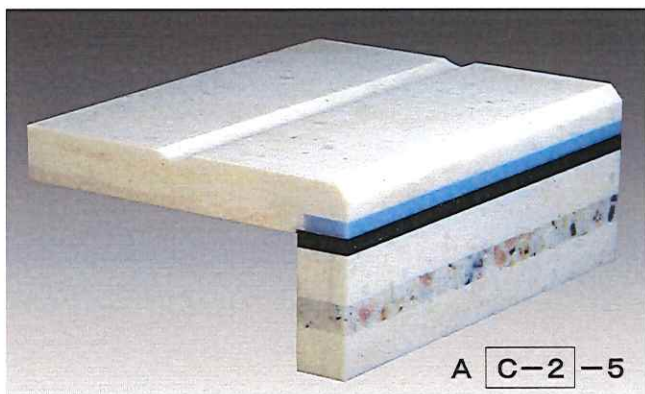
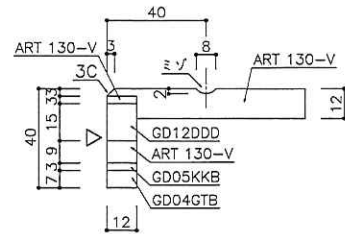
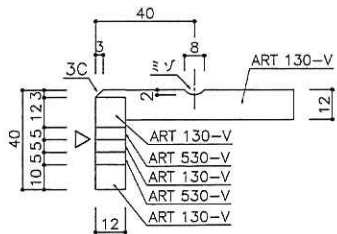
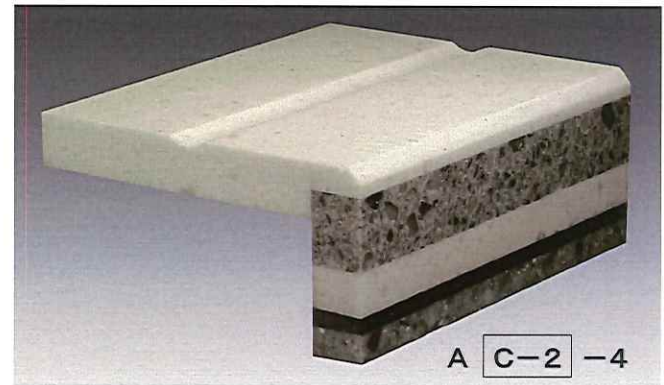
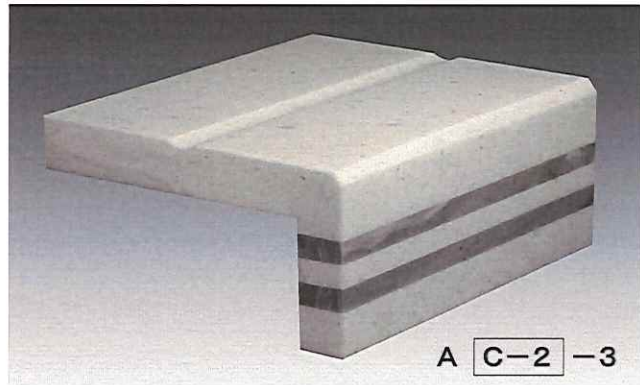
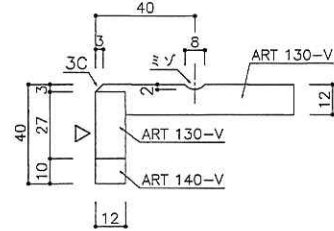
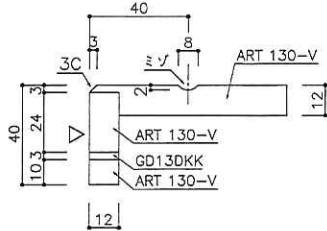
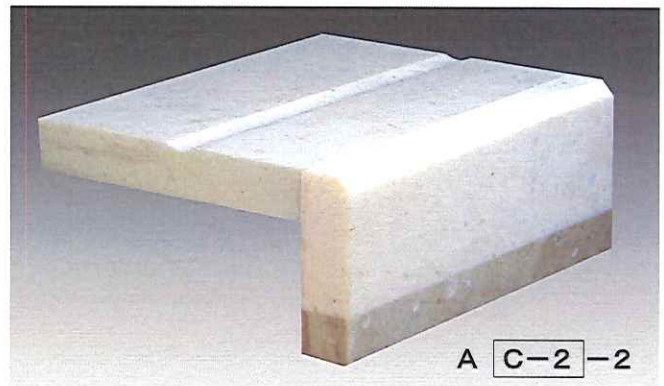
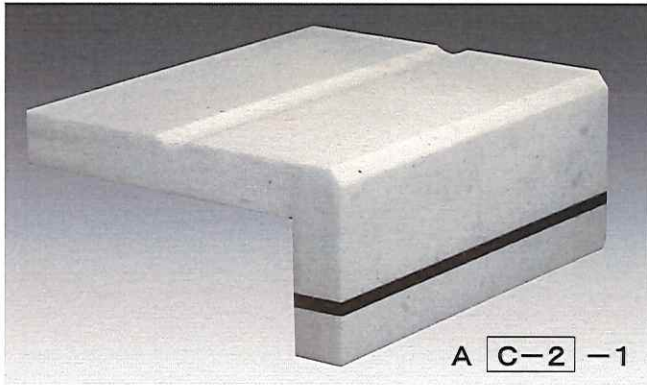

ノンドリップの溝に関しては、幅 8 mm(又は 6 mm)、深さ 2 mmの方が、betterとされます。

カルチャードマーブルでしかできないこと！

アクセントライン …………… ノンドリップへの回帰

(86 & 86プラス 20)

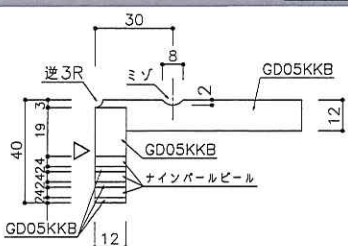
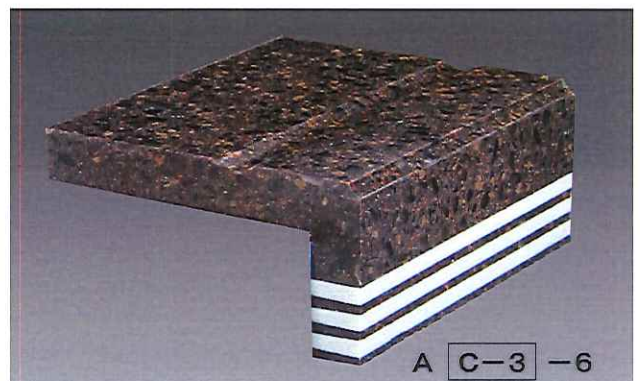
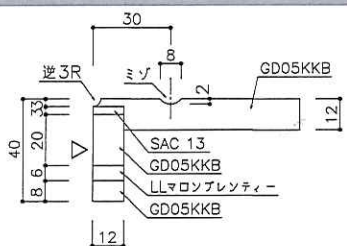
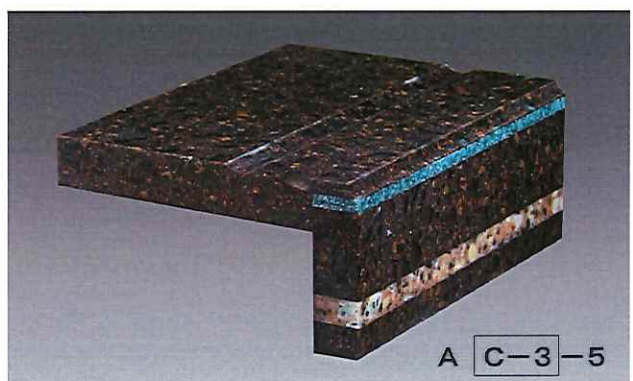
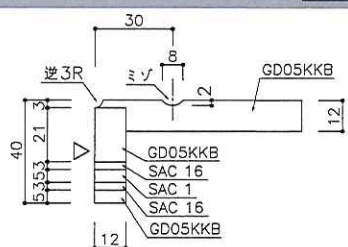
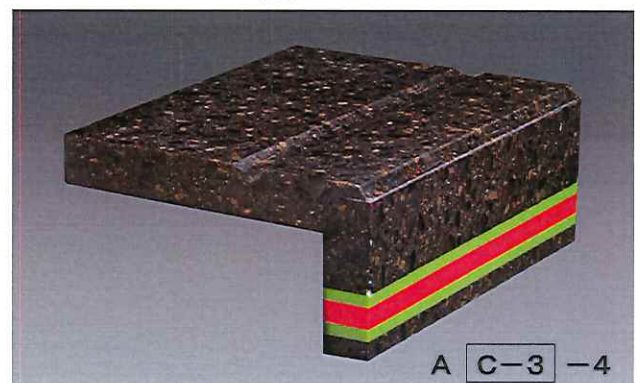
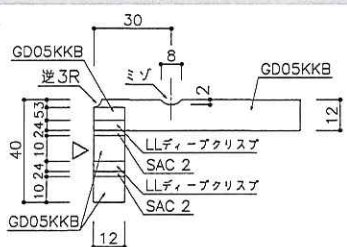
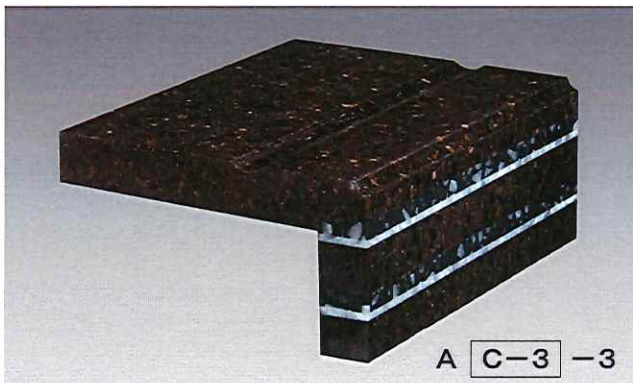
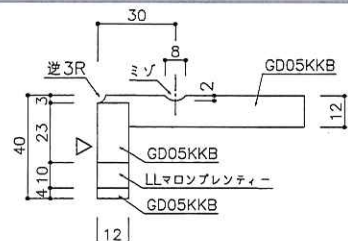
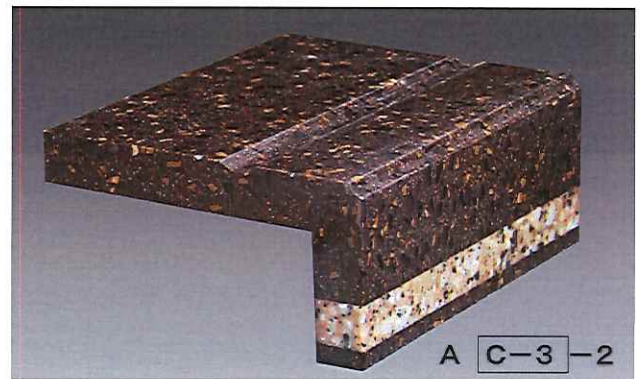
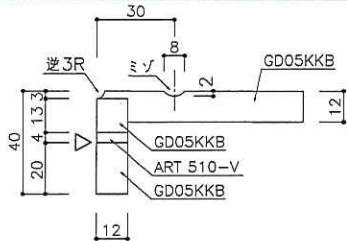
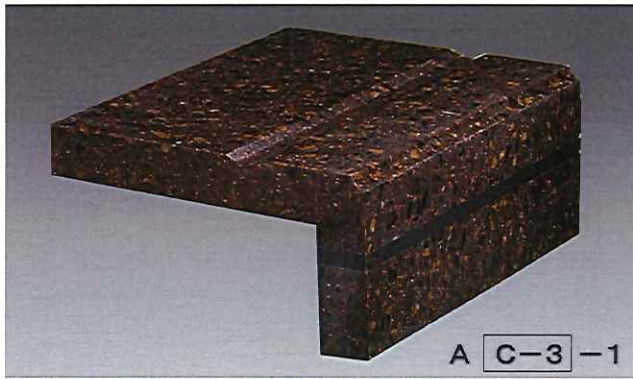

ノンドリップの溝に関しては、幅 8 mm(又は 6 mm)、深さ 2 mmの方が、better と思われます。

カルチャードマーブルでしかできないこと！

アクセントライン …………… ノンドリップへの回帰

(86 & 86プラス 20)

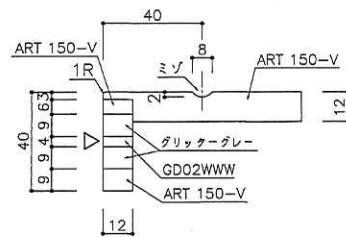
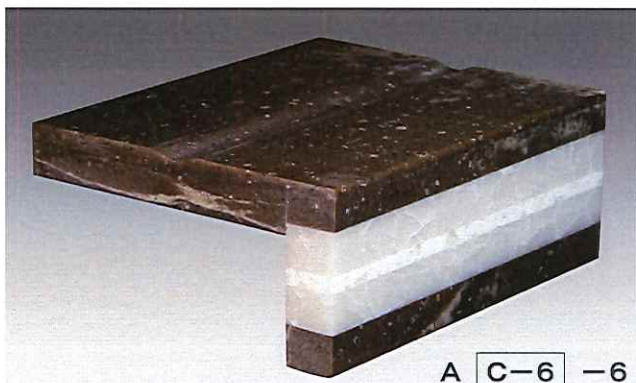
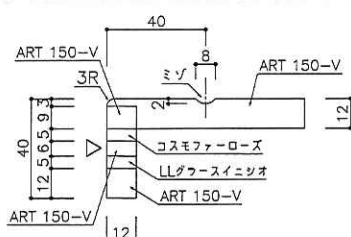
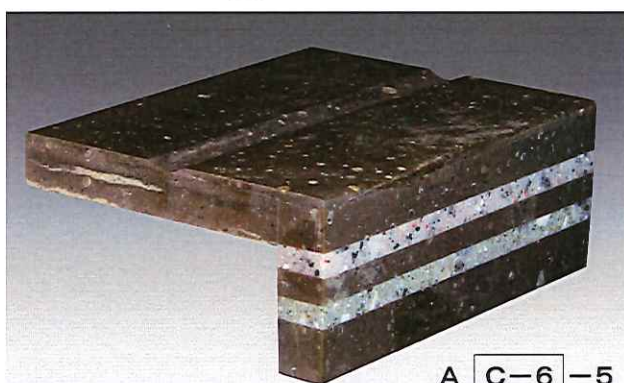
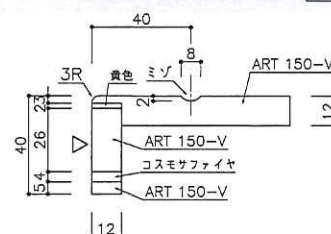
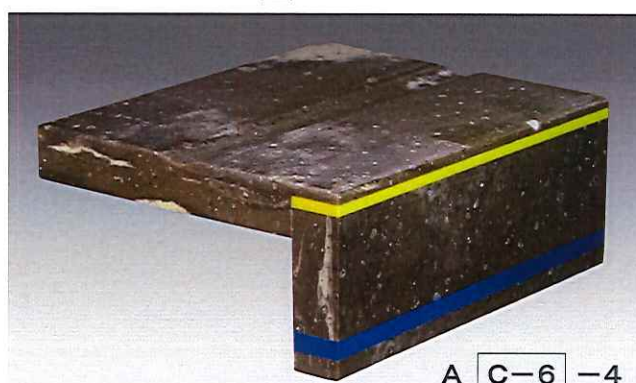
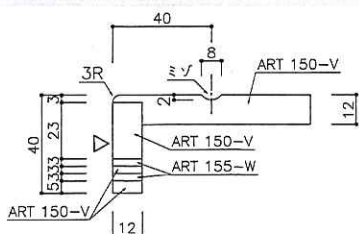
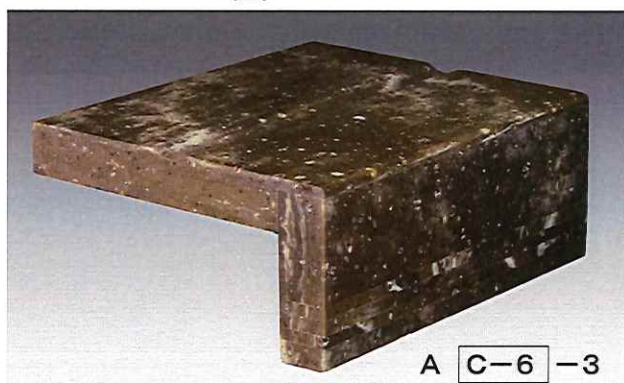
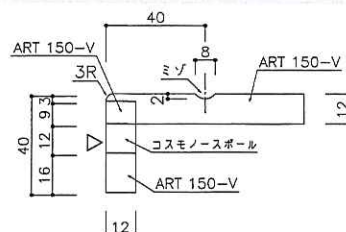
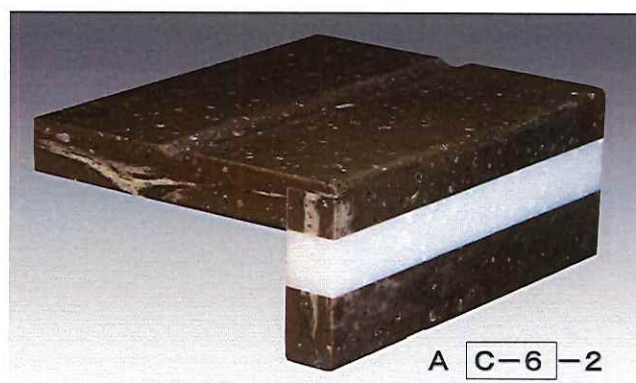
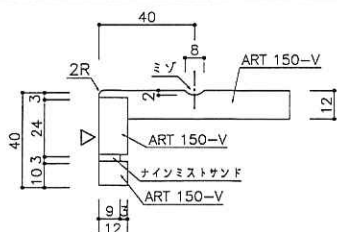
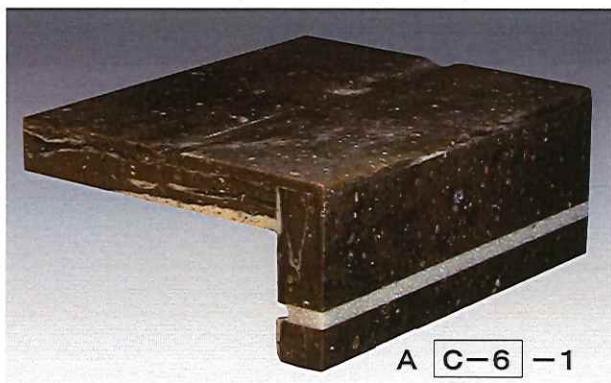

ノンドリップの溝に関しては、幅 8 mm(又は 6 mm)、深さ 2 mmの方が、betterと思われます。

カルチャードマーブルでしかできないこと！

アクセントライン …… ノンドリップへの回帰

(86 & 86プラス 20)

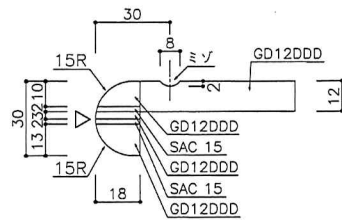
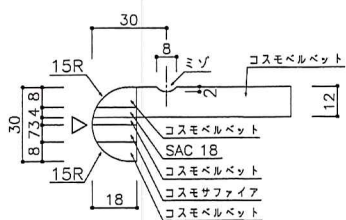
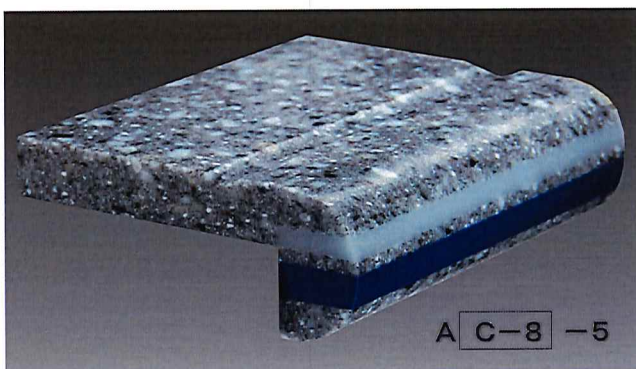
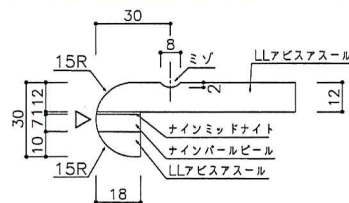
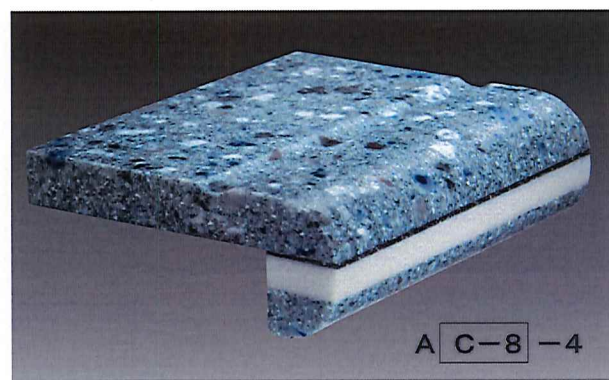
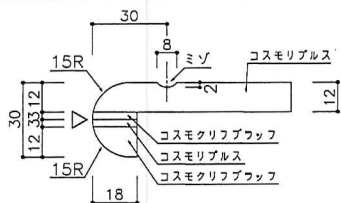
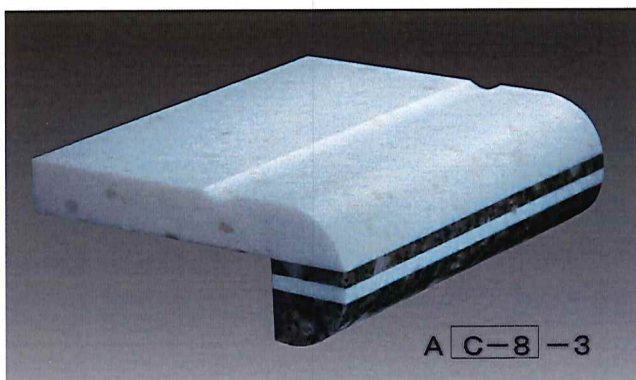
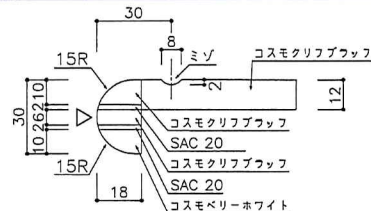
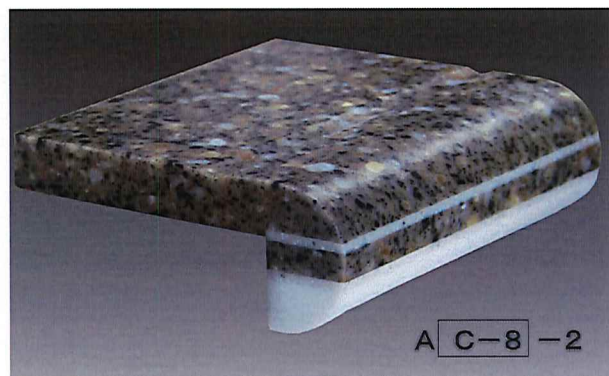
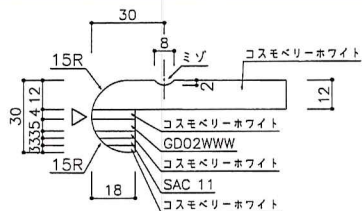
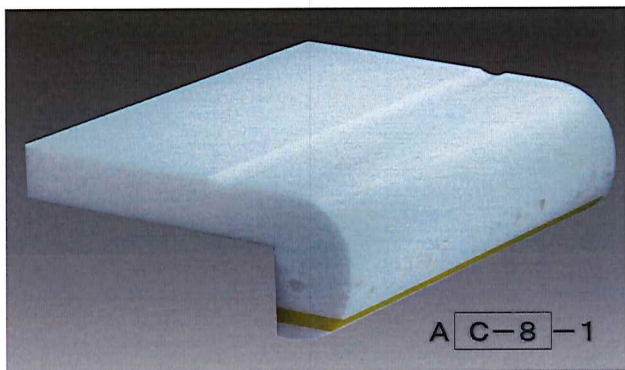

ノンドリップの溝に関しては、幅 8 mm(又は 6 mm)、深さ 2 mmの方が、betterとされます。 R3年 3月